

# TRANSGENERATIONAL

The 11th International  
Arts and Design Symposium 2023

# TRANSGENERATIONAL

The 11th International  
Arts and Design Symposium 2023

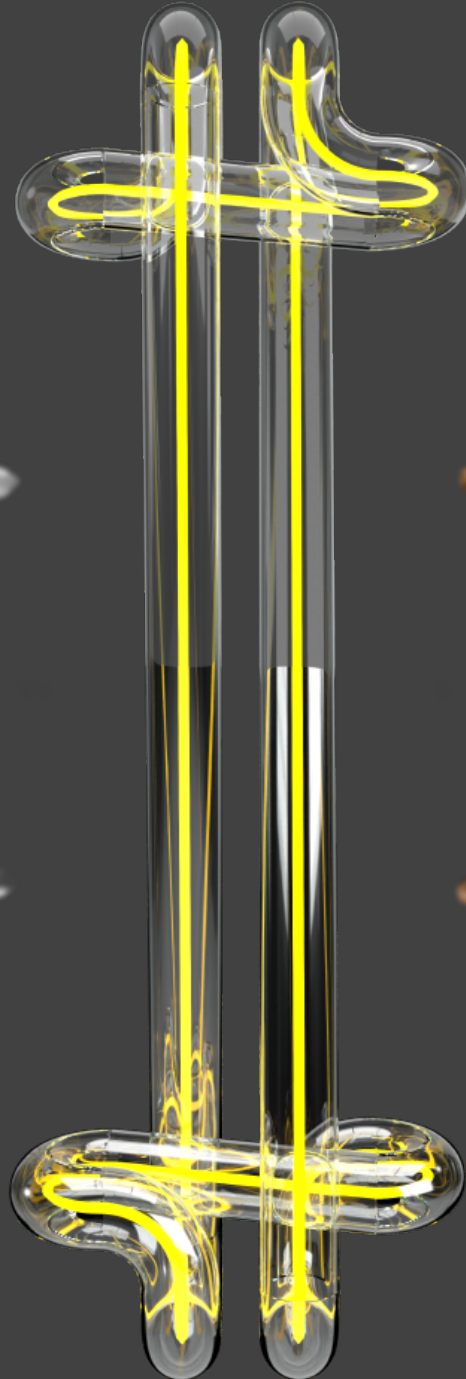

# TRANSGENERATIONAL

The 11th International  
Arts and Design Symposium 2023

by Council of Arts and Design Deans of Thailand (CADDT) and The Association of Siamese Architects under the Royal Patronage (ASA) together with the Faculty of Digital Arts, College of Design and the Faculty of Architecture Rangsit University.



[www.workinprogress-symposium.design](http://www.workinprogress-symposium.design)

# EXECUTIVE COMMITTEE

Prof. Ekchart Joneurairatana

Silpakorn University, Thailand

Prof. Kamol Phaosavadi

Chulalongkorn University, Thailand

Assoc. Prof. Pisrapai Sarasalin

Dean of College of Design, Rangsit University, Thailand

Somchai Jongsaeng

Silpathon Award in Design, Thailand

Chookiat Likitpunyarut

Senior designer and artist, Designer of the year committee, Thailand

Jitsing Somboon

(Head of Designer, Greyhound, Thailand) Assoc. Prof. Dr. Tan Jeanne  
(Institute of Textiles & Clothing, The Hong Kong Polytechnic  
University, Hong Kong)

Franyo Aatoth

Artist Creator of exceptional graphic works, France

Geri Forkner

Textile Artist, USA

Prof. Kaname Yanagisawa

Architect, Chiba University, Japan

Prof. DeDeniz Hasidic

İzmir Ekonomi Üniversitesi, Turkey

Marco Corbella

Architect/Designer, Italy

Asst. Prof. Andrew I-kang Li, Ph.D.

Kyoto Institute of Technology, Japan

Asst. Prof. Walaiporn Nakapan, Ph.D.

Architect, Founder of Parabolab, Thailand

Assoc. Prof. Chaiyasit Dankittikul, Ph.D.

Silpakorn University, Thailand

Assoc. Prof. Dr. Raksarn Wannawattawong

Chulalongkorn University, Thailand

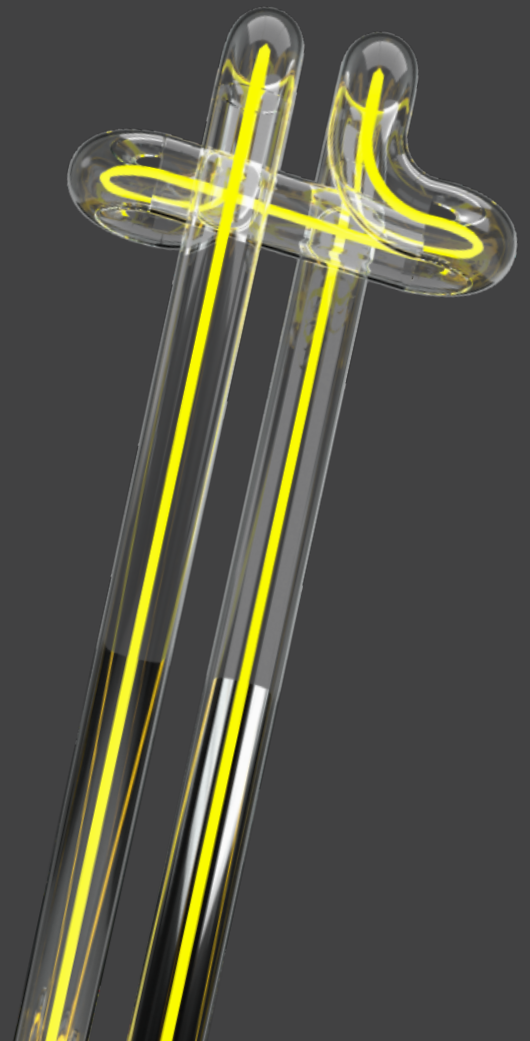

# JEDI – WIHARN – LARNTHAM

Mr.Tawan Wongsawan

---

## Introduction :

From the need to build a pagoda temple for enshrine the Jadeite Buddha, including the improvement of the Wiharn of Somdej Ong Pathom along with adjusting the front entrance courtyard area. It is the origin of the Chedi - Wihan - Lan Tham design project. The design concept aims to create Buddhist architecture that reflects Thainess in a universal way & Thainess is so simple.

## Objectives:

From the need to build a pagoda temple for enshrine the Jadeite Buddha, including the improvement of the Wiharn of Somdej Ong Pathom along with adjusting the front entrance courtyard area. It is the origin of the Chedi - Wihan - Lan Tham design project.

---

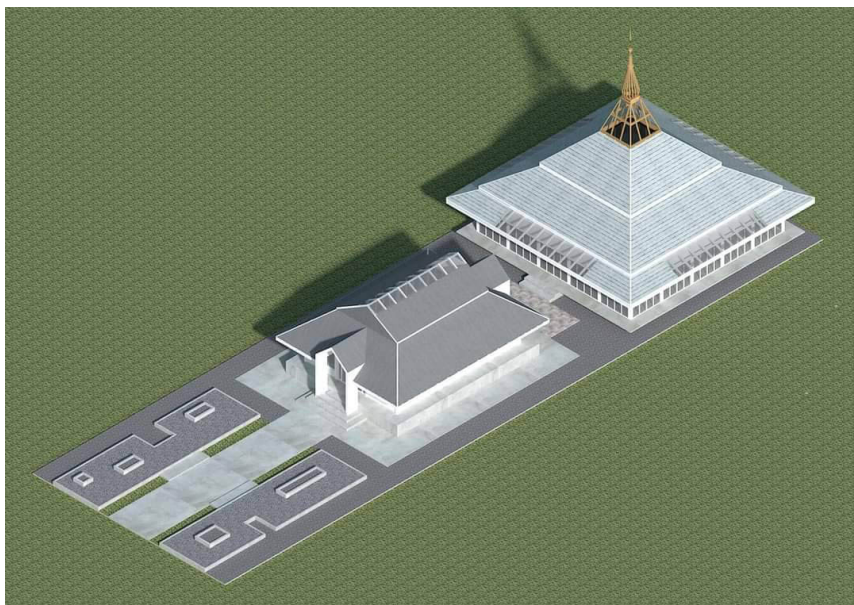
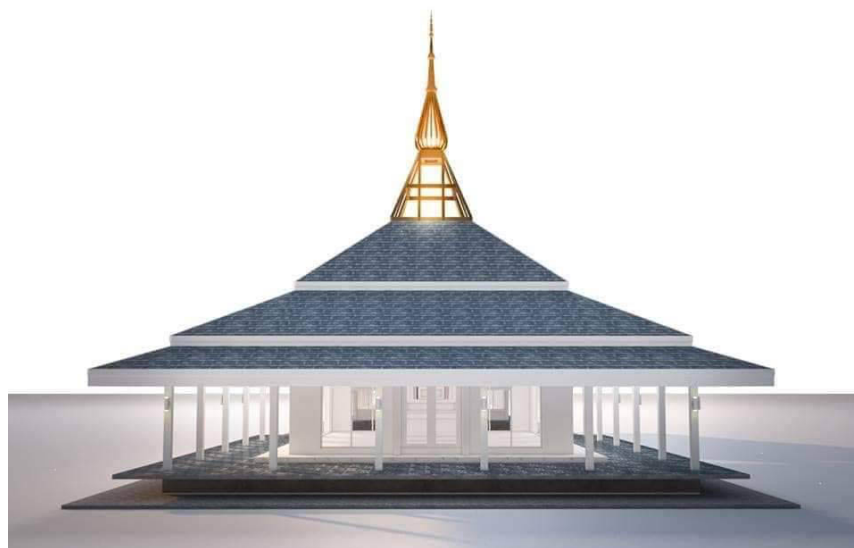

## Process or Concept / Methodology:

The design concept aims to create Buddhist architecture that reflects Thainess in a universal way and shows Dharma - Nature - Ordinary.

- The front courtyard has been renovated into a meditation courtyard that is simple and harmoniously with nature.
- Wihan Ong Somdet Phra Pathom use the original layout. The entrance is a contemporary simple gable shape.
- Temple of the Jade Buddha designed to be accessible from all directions. The top is a replica of Phra That Kham Kaen which is a priceless pagoda of Khon Kaen Province.

## Conclusion:

-

## Techniques and Materials:

-

## References:

-

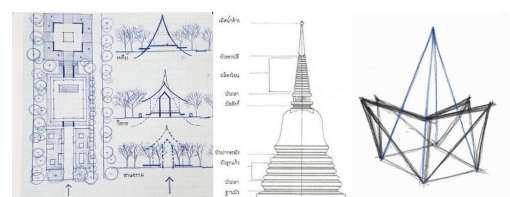
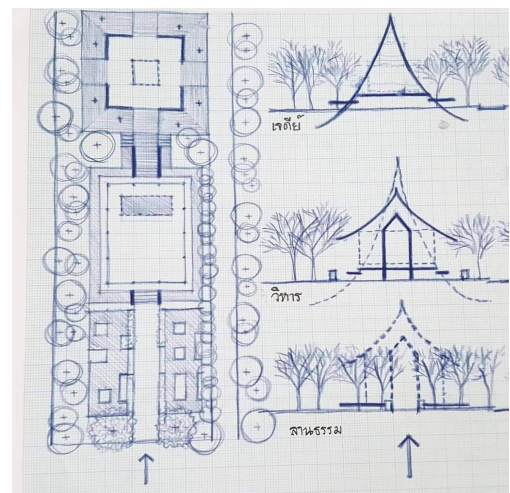
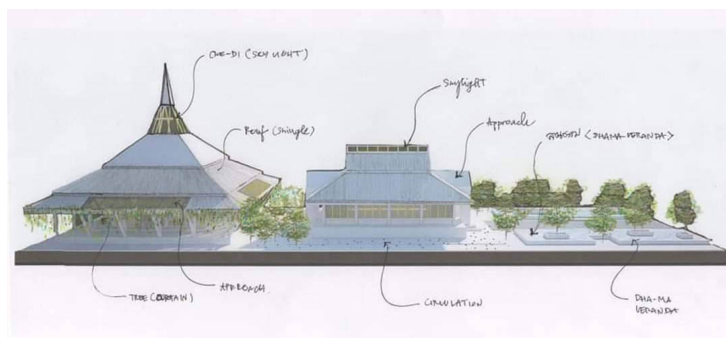
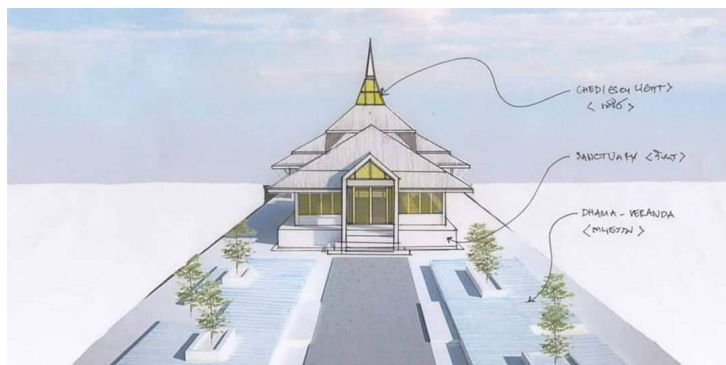



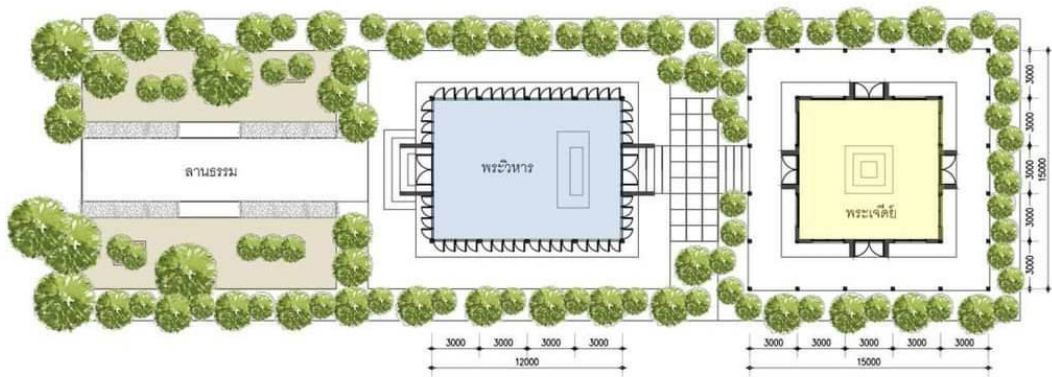
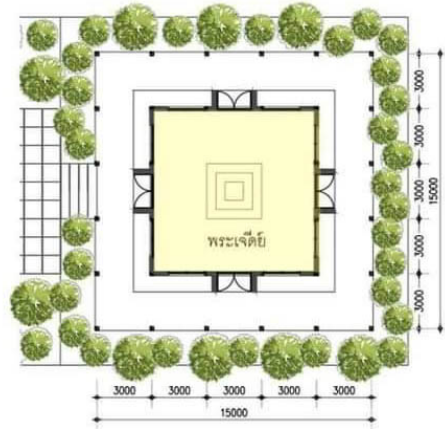

Scale 1: 200 [A3]

